

SECTION A-A

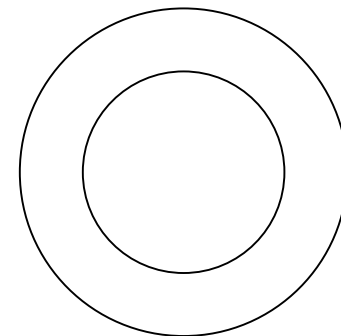
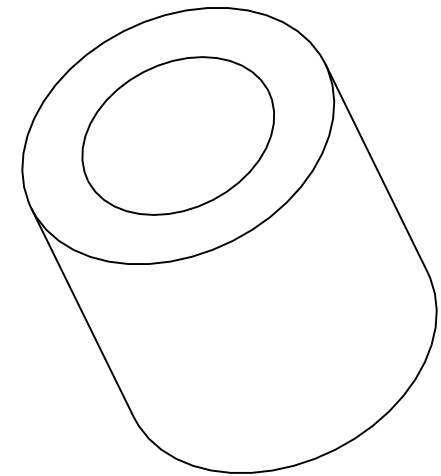

All dimensions in inches

NOTE 1: Impregnated with 100 Grade R&O turbine oil unless otherwise specified

NOTE 2: Bars will finish to dimensions shown

MATERIAL:  
 FC-2000-K30 (SAE 863)  
 Sintered Iron/Copper

DRAWING NOT TO SCALE

**SYMMCO INC.**  
 Iron/Copper Cored Bar Stock  
**FCCS-4802**  
 3 ID X 4-7/8 OD X 5 LEN